

CITY OF KERMAN WATER MASTER PLAN ALTERNATIVE #1

2007 KERMAN GENERAL PLAN UPDATE

MAP
19

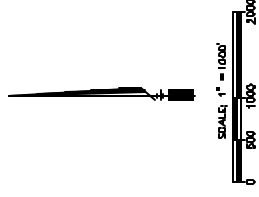

LEGEND:
 - - - - - MASTER PLAN WATER MAIN
 - - - - - EXISTING WATER MAIN
 - - - - - WELL (EXISTING & MASTER PLAN)

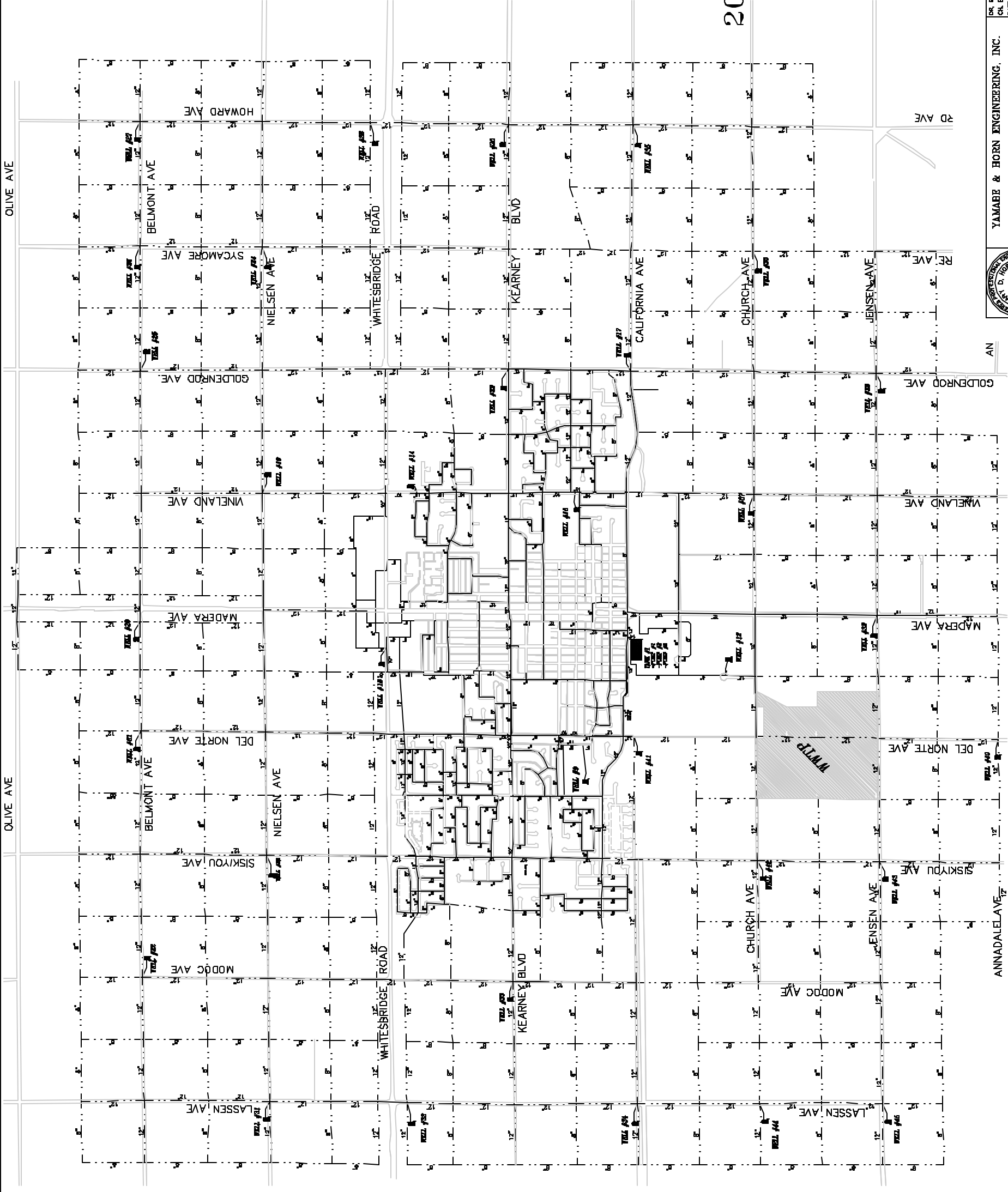

YAMABE & HORN ENGINEERING, INC.
 CIVIL ENGINEERS - LAND SURVEYORS
 1300 E. SHAW AVE. SUITE 178, FRESNO, CALIFORNIA 93710
 PHONE: (559) 244-3123 FAX: (559) 244-3120

DR. BY: JH	PROJECT TITLE: CITY OF KERMAN MASTER PLAN	JOB NO. 07-001
CHK. BY: JH	CITY OF KERMAN	
DATE: 3/28/07	WATER MASTER PLAN ALTERNATIVE #1	SHEET NO. 1 OF 1